

CUSTOM RANCH

3540 Voda Dr.
Milton, WI
The Ridges, Lot 36

OFFERED AT \$389,900

Estimated Completion: November 2021

Located in The Ridges subdivision, where you can enjoy an inviting neighborhood in a rural-like setting.

This custom ranch is built just for you! You will find many customized and upgraded features, as well as ample space. Make this your next home sweet home today!

SCHEDULE A SITE/HOME TOUR

Kelsey Paasch, Director of Sales & Operations
P: 608.756.2989 x 103
E: info@buildadvantagehomes.com
W: buildadvantagehomes.com

MAIN FEATURES

- ✓ 1,808 sq. ft.
- ✓ 3 bedrooms
- ✓ 2 baths

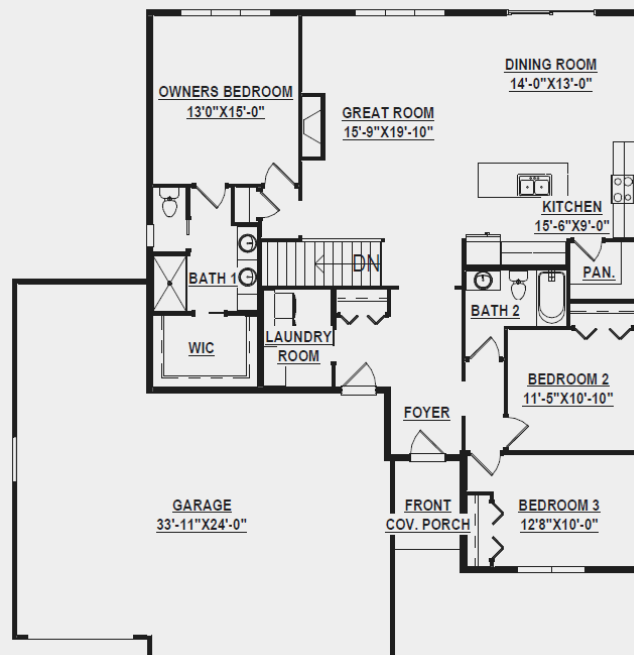

“I’m very happy with the quality construction, energy efficiency, and timely performance of your Advantage Homes team and would happily recommend building with you to anyone!”



HOME HIGHLIGHTS

Focus on Energy certified & 3rd-party inspected
Structural 10-year warranty
GAF Dimensional shingles 50-year/lifetime warranty
Sump pump system
Passive radon system
Egress window & window well
Water softener system w/ a 40-gallon water heater
Cathedral ceiling in Great Room
Tray ceiling in Main Bedroom
Pella 250 windows
Direct vent gas fireplace
Hickory stained cabinets & vanities
Soft-close drawers & cabinet doors
Luxury vinyl in great room/kitchen/dining room
Quartz kitchen countertop
Hickory stained laundry cabinets
Dishwasher & microwave
Rough-in for full LL bath in basement
12' x 12' exterior rear concrete patio
Fine grade & seeding of lawn
Concrete sidewalk & driveway

