

CUSTOM RANCH

4318 Scottys Dr
Janesville, WI
Terneus Estates - Lot 24

OFFERED AT \$439,000

Estimated Completion: July 2024

Located in Terneus Estates subdivision, where you can enjoy an inviting neighborhood in a rural-like setting.

This custom ranch is an attractive home plan, complemented with an airy and open design that is great for entertaining.

MAIN FEATURES

1,601sq. ft. | 3 bedrooms | 2 baths



Main Level
1,601 sq. ft.

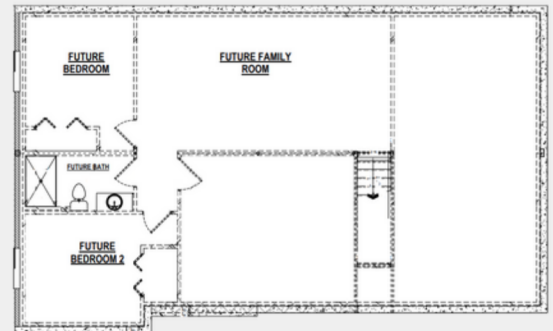

Future Lower Level
1,587 sq. ft.

J-2321 | 04.17.24

SCHEDULE A TOUR OF THIS HOME!

Ryan White
VP of Sales & Marketing
608.756.2989 x 141
ryan@buildadvantagehomes.com



Tina Gould
Director of Condominium & MLS Sales
608.756.2989 x 106
tina@buildadvantagehomes.com



HOME HIGHLIGHTS

Focus on Energy certified & 3rd-party inspected
Structural 10-year warranty
GAF Dimensional shingles w/ 50-year/lifetime warranty
Sump pump system
Passive radon system
Water softener system w/ 40-gallon water heater
Alliance windows
Interior painting package
9' ceiling height on the main level
Cathedral ceilings in the kitchen, great room, & dining room
Split-bedroom floorplan
Upgraded LVP flooring in main areas, carpet in bedrooms
Direct vent gas fireplace w/ facing to mantle
Maple stained cabinets in kitchen & bathrooms
Tiled kitchen backsplash
Soft-close drawers & cabinets throughout
Quartz kitchen countertop
Dishwasher & microwave included
Owner's suite w/ large walk-in closet
Additional laundry cabinets
12' x 14' rear exterior patio
3-car garage
Fine grade & seeding of lawn
Landscape package included
Concrete sidewalk & driveway



Features are subject to change, buyer to verify