

# MODIFIED WHISTLER RIDGE

3613 Voda Dr.  
Milton, WI  
*The Ridges - Lot 176*

## OFFERED AT \$439,500

Estimated Completion: June 2025



FIND YOUR NEW HOME AT



Located in The Ridges subdivision, where you can enjoy an inviting neighborhood in a rural-like setting.

This Modified Aberdeen is an attractive home plan, complemented with an airy and open design that is great for entertaining.

### SCHEDULE A TOUR OF THIS HOME!

Ryan White  
VP of Sales & Marketing  
608-921-4448  
ryan@buildadvantagehomes.com



Tina Gould  
Director of Condominium & MLS Sales  
608-590-6202  
tina@buildadvantagehomes.com

## MAIN FEATURES

1,593 sq. ft. | 3 bedrooms | 2 baths

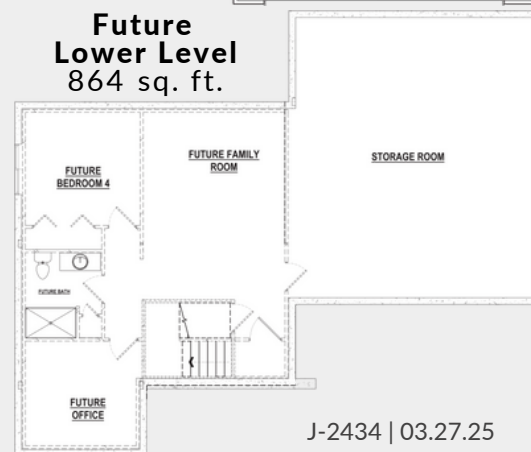

J-2434 | 03.27.25



## HOME HIGHLIGHTS

Focus on Energy certified & 3rd-party inspected  
Structural 10-year warranty  
GAF Dimensional shingles w/ 50-year/lifetime warranty  
Sump pump system & Passive radon system  
Water softener system w/ 40-gallon water heater  
Egress window w/ well  
Pella 250 windows  
Interior painting package  
9' ceiling height in main level & in basement  
Cathedral ceiling in great room & entry  
Upgraded LVP flooring  
Maple stained & painted cabinets  
Soft-close drawers & cabinet doors  
Quartz kitchen countertop  
Dishwasher & microwave included  
Owner's suite w/ walk-in closet  
12' x 14' rear exterior patio  
2-car garage with extra storage  
Sleek, contemporary exterior elevation  
Fine grade, seeding of lawn  
Landscaping package included  
Concrete sidewalk & driveway



*Features are subject to change, buyer to verify*