



MODIFIED BRADENTON

3506 Samson Dr.
Milton, WI
The Ridges - Lot 190

OFFERED AT \$524,900

Estimated completion: July 2026
Price subject to change after final selections are made



FIND YOUR NEW HOME AT



Located in The Ridges subdivision, where you can enjoy an inviting neighborhood in a rural-like setting.

This Modified Bradenton is an attractive home plan, complemented with an airy and open design that is great for entertaining.

SCHEDULE A TOUR OF THIS HOME!

Ryan White
VP of Sales & Marketing
608-921-4448
ryan@buildadvantagehomes.com



Tina Gould
Director of Condominium & MLS Sales
608-590-6202
tina@buildadvantagehomes.com

MAIN FEATURES

1,651 sq. ft. | 3 bedrooms | 2 baths



Main Level
1,651 sq. ft.

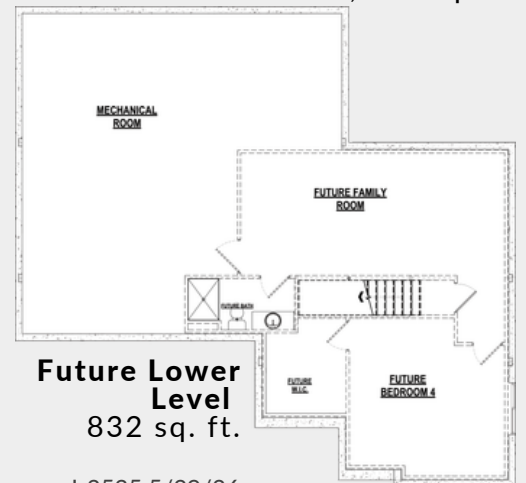

Future Lower Level
832 sq. ft.

J-2535 5/29/26



HOME HIGHLIGHTS

- Focus on Energy certified & 3rd-party inspected
- Structural 10-year warranty
- GAF Dimensional shingles w/ 50-year/lifetime warranty
- Sump pump system & Passive radon system
- Water softener system w/ 40-gallon water heater
- Egress window w/ well
- Pella 250 windows
- Interior painting package
- Electric fireplace
- 9' ceiling height in main level & in basement
- Tray ceilings in the owner's bedroom & great room
- Upgraded LVP flooring
- Maple cabinets & vanities
- Soft-close drawers & cabinet doors throughout
- Quartz kitchen countertop
- Tiled kitchen backsplash
- Dishwasher & microwave included
- Laundry on the main floor
- Owner's suite w/ walk-in closet
- 3-car garage
- 16' x 13' rear covered porch
- Fine grade, seeding of lawn
- Landscaping package included
- Concrete sidewalk & driveway



Features are subject to change, buyer to verify